

Modern Bathroom Cabinet

FILLS NEEDS OF LARGE HOUSEHOLD

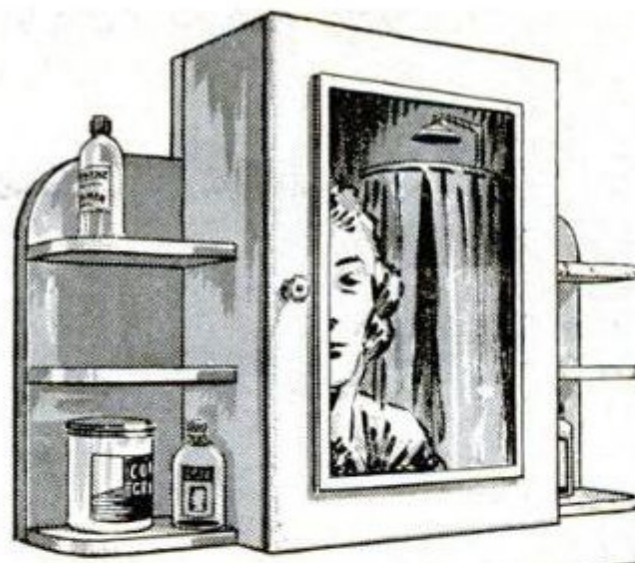

EVERY home needs a capacious bathroom cabinet. The one shown is easily made, convenient to use, and much larger than usual.

Two shelves are put inside the cabinet proper, spaced 5" and 10½" respectively from the bottom. This brings them between the outside shelves so that all the shelves can be attached without difficulty. In assembling, attach the four boards forming the cabinet to the back; then add the outside shelves, and finally the inside shelves, using 1" flat-head wood screws.

Hang the door with 1" brass butt hinges. The mirror, 10" by 16", is held with a simple molding.

One coat of flat white paint and two coats

of white enamel are applied, and a glass knob and spring-type door catch added. The cabinet is mounted with two ¼" by 2½" lag screws set into expansion shields so that the comparatively heavy weight will be solidly supported.—CHARLES BATTY.

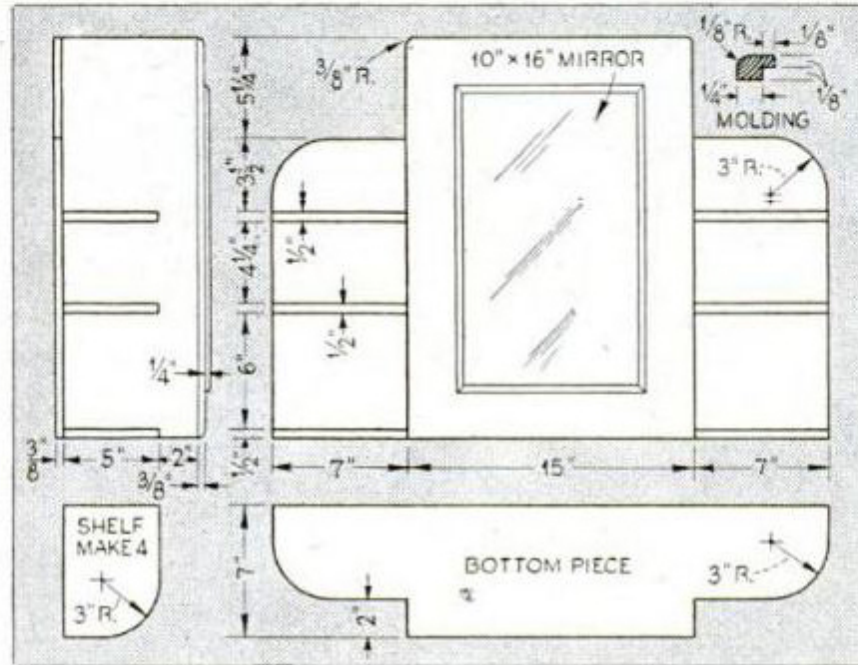

The door is ⅜" plywood 15" by 20½"; the back is cut from same material 20½" by 29". Remainder of stock is ½" white pine. Use 1" screws in assembling

